

PCB Piezotronics Inc. claims proprietary rights in the information disclosed hereon. Neither it nor any reproduction thereof will be disclosed to others without the written consent of PCB Piezotronics Inc.

75595

REVISIONS		
REV	DESCRIPTION	DIN
NR	RELEASED TO DRAFTING	53614

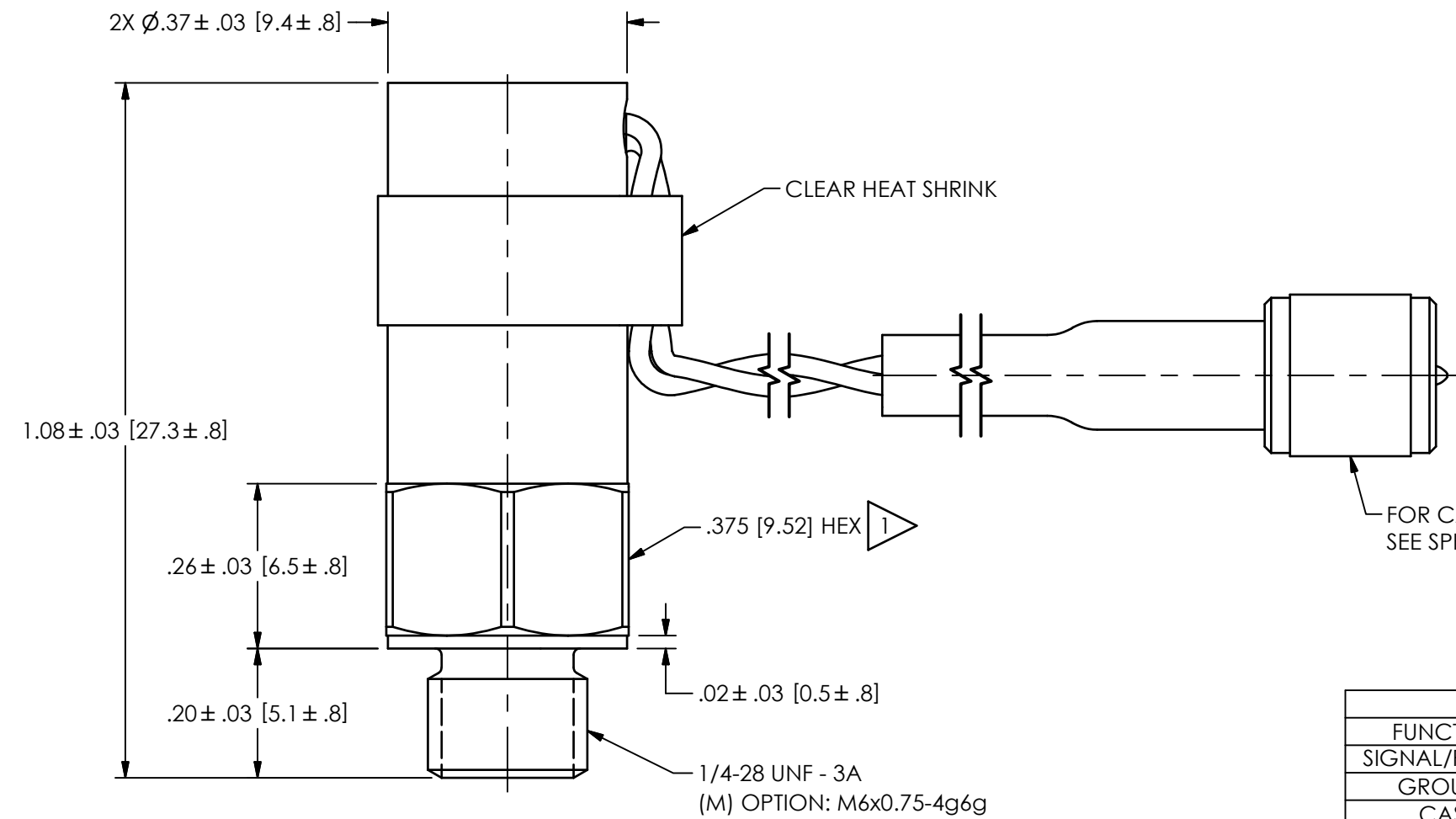

PIN OUTS		
FUNCTION	031	EB
SIGNAL/POWER	RED	CENTER PIN
GROUND	WHITE	SHELL
CASE	N/A	N/A

**MOUNTING HOLE PREPARATION**  
 $\varnothing.22 \pm .03$  [5.4 ± .8]  $\nabla.30 \pm .03$  [7.6 ± .8] MIN  
 1/4-28 UNF-3B  $\nabla.20 \pm .03$  [5.1 ± .8] MIN

**(M) OPTION**  
 $\varnothing.21 \pm .03$  [5.9 ± .8]  $\nabla.30 \pm .03$  [7.6 ± .8] MIN  
 M6x0.75-6H  $\nabla.20 \pm .03$  [5.1 ± .8] MIN

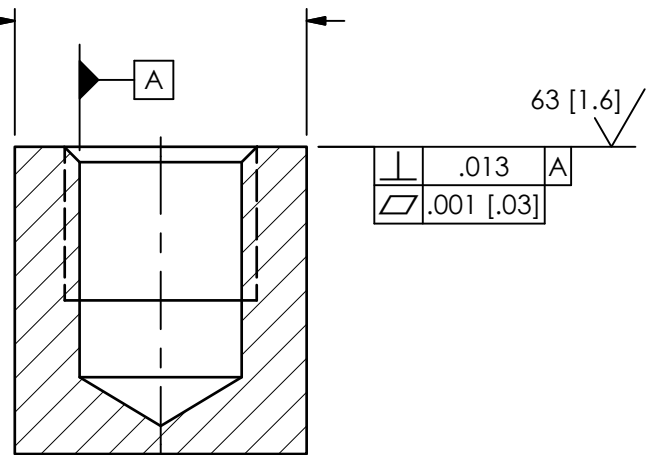

1 RECOMMENDED MOUNTING TORQUE ON .375 [9.52] HEX: 2.5 - 4 FT-LBS [3.4 - 5.4 N-m]

UNLESS OTHERWISE SPECIFIED TOLERANCES ARE:		DRAWN		CHECKED		ENGINEER			
DIMENSIONS IN INCHES DECIMALS XX ±.01 XXX ±.005 ANGLES ± 2 DEGREES		DIMENSIONS IN MILLIMETERS [ IN BRACKETS ] DECIMALS X ± 0.3 XX ± 0.13 ANGLES ± 2 DEGREES		NJF	03/03/23	JDM	03/03/23		
CABLE TOLERANCES IN ENGLISH 1" ≤ LENGTH < 1' = +1' / - 0 1' ≤ LENGTH < 5' = +2' / - 0 5' ≤ LENGTH < 100' = +6' / - 0 100' ≤ LENGTH = +1' / - 0		CABLE TOLERANCES IN METRIC 2.54cm ≤ LENGTH < 30.5cm = +2.54cm / - 0 30.5cm ≤ LENGTH < 1.5m = +5.1cm / - 0 1.5m ≤ LENGTH < 30.5m = +15.2cm / - 0 30.5m ≤ LENGTH = +30.5cm / - 0		TITLE INSTALLATION DRAWING MECHANICALLY FILTERED SHOCK ACCELEROMETER 350M88A				<b>PCB PIEZOTRONICS</b> AN AMPHENOL COMPANY 3425 WALDEN AVE. DEPEW, NY 14043 (716) 684-0001 E-MAIL: sales@pcb.com	
FILLETS AND RADII .003 - .005		FILLETS AND RADII 0.07 - 0.13		CODE IDENT. NO. 52681		DWG. NO. 75595			
				SCALE: 4X		SHEET 1 OF 1			